

Megapixel Camera Lens

User Manual

SLA-M8550D



Hanwha Vision cares for the environment at all product manufacturing stages, and is taking measures to provide customers with more environmentally friendly products. The Eco mark represents Hanwha Vision's devotion to creating environmentally friendly products, and indicates that the product satisfies the EU RoHS Directive.

CONTENTS

LENS	3
PART NAMES AND FUNCTION	3
IRIS	3
HOW TO ASSEMBLE LENS AND CS MOUNT CAMERA	4
WIRING	4
DIMENTION	5
SPECIFICATION	6

OPERATING INSTRUCTIONS

Lens is aimed at sharp, crisp images and exposure accuracy under even the most adverse lighting conditions. The iris auto-close function protects imagers and optical filters from extreme high lights when power is off. To receive the best possible results, read the instruction manual carefully before using the lens.

LENS

This lens embeds ND filter and takes auto iris function by Galvanometer. It has self focus and mount control function, operates DC iris function through lens and attached cable. This lens shows the best performance in the daytime environment.

PART NAMES AND FUNCTION

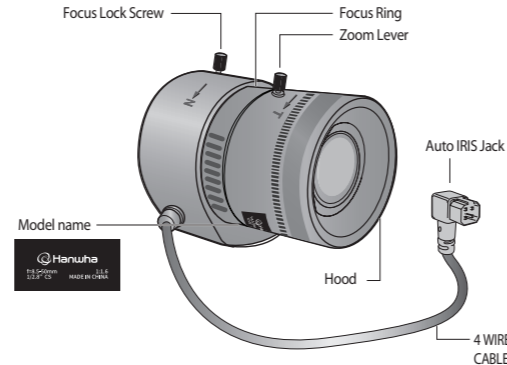

IRIS

This lens have a built-in ND filter and iris by Galvanometer. This iris tool is driven by inner circuit of camera. If power is off, its state is locked.

HOW TO ASSEMBLE LENS AND CS MOUNT CAMERA

- 1) Turn the lens clockwise to lock onto camera part mount screw. (When the lens locks successfully, it can turn around SLIP state)
- 2) Turn clockwise until stop by stopper even if it almost SLIP state.
- 3) From that point, turn the lens counter clockwise to rotate it in the SLIP state by up to. In such a way, you can adjust the lens to a desired position.
- 4) Connect the lens cable to the appropriate camera connector.
- 5) Finally, use the focus Ring and zoom lever to fit the zoom factor and focus. Then, fix the lens with the camera.

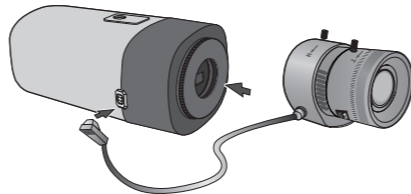

This lens takes CS mount type so should be used 12.5mm FLANGE-BACK setting camera.

WIRING

1	Brown	Control(-)
2	Red	Control(+)
3	Yellow	Drive (+)
4	Orange	Drive (-)

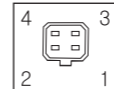

Dimension

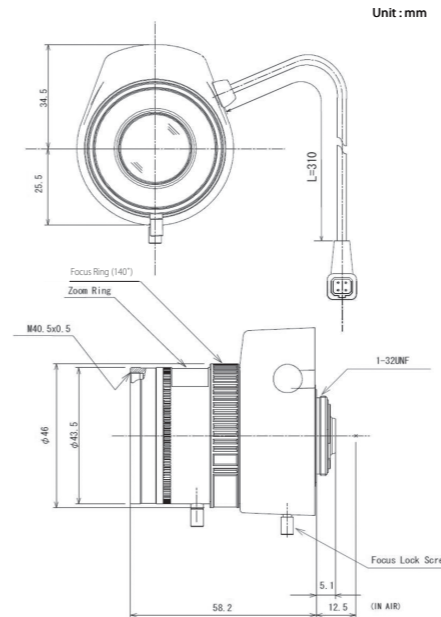

SPECIFICATION

Model	SLA-M8550D	
Imager Size	1/2.8"	1/3"
Focal Length	8.5~50mm	
Max. Resolution	3 Mega-Pixel	
Max. Aperture Ratio	1:1.6	
Max. Image Format	5.12mm x 3.84mm (Max ø6.7)	
Operation	Iris	DC Auto Iris (F1.6~360C)
	Focus	Manual (1.0m ~Inf.)
	Zoom	Manual(8.5~50mm)
Angle of View	Diagonal	42.3° ~ 7.5°
	Horizontal	35.7° ~ 6.3°
	Vertical	22.3° ~ 4.0°
Back Focal Length	10.7mm(0.42")	
Flange Back Length	12.5mm (0.49") (In Air)	
Mount	CS-mount	
Dimension (W x H x D)	46 x 60 x 58.2mm(1.81" x 2.36" x 2.29")	
Operating Temperature	-10°C ~ +50°C (+14°F ~ +122°F)	
Weight	80g (0.176lb)	
IR Corrected	not support	

한화비전(주)

경기도 성남시 분당구 판교로 319번길 6 (삼평동 701)
영 업 TEL 070-7147-8771~9 A/S 및 기술문의 1588-5772
부산영업소 TEL 051-796-3216
대구영업소 TEL 053-742-3098
광주영업소 TEL 062-941-9559
대전영업소 TEL 042-489-9840
www.HanwhaVision.com

Head Office

6, Pangyo-ro 319 beon-gil, Bundang-gu, Seongnam-si,
Gyeonggi-do, 463-400 Rep. of KOREA
Tel : +82.70.7147.8753 Fax : +82.31.8018.3740
www.HanwhaVision.com

Hanwha Vision America

500 Frank W. Burr Blvd. Suite 43 Teaneck, NJ 07666
Toll Free : +1.877.213.1222 Direct : +1.201.325.6920
Fax : +1.201.373.0124
www.HanwhaVisionAmerica.com

Hanwha Vision Europe

Heriot House, Heriot Road, Chertsey, Surrey, KT16 9DT, United Kingdom
Tel : +44.1372.235663 Fax : +44.1932.57.8101
www.HanwhaVision.eu

Hanwha Vision Middle East FZE

JAFZA View 18, 20th floor, office 2001, 2002, 2003, Downtown Jebel Ali,
Dubai, United Arab Emirates
www.HanwhaVision.com

Hanwha Vision Vietnam Hanoi Office

28th Floor, Handico Building, Pham Hung Street, Me Tri ward, Nam Tu Liem District, Hanoi City, Vietnam
Tel : +84.91.982.40.88
www.HanwhaVision.com